



# X-FB-E, X-DFB-E DATA SHEET

**Electrical conduit fastener**



# X-FB-E, X-DFB-E Electrical conduit fastener

## Product data

### Dimensions

X-FB-E

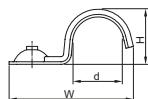

X-DFB-E

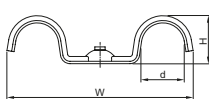

X-GN 20/27

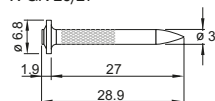

X-GHP 20

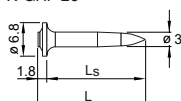

X-C 22/27

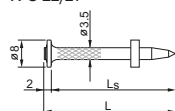

X-P 20 G3 MX

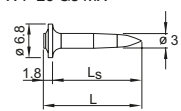

X-P 20 B3 MX

X-C 20 B3 MX

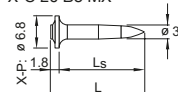

X-C 20/27 G3 MX

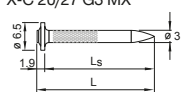

### General information

#### Material specifications

Galvanized steel sheet  $f_u = 270-420 \text{ N/mm}^2$   
10-20  $\mu\text{m}$  zinc coating

#### Recommended fastening tools

GX 120-ME, GX 3 ME, BX 3 ME,  
DX 351-MX, DX 351-F8 DX 460-MX,  
DX 460-F8 DX 5 MX, DX 5 F8

See **X-FB-E fastener program** in the next pages for more details.

## Applications

### Example



**X-FB-E for rigid conduits**



**X-FB-E for flexible conduits**

## Load data

### Recommended loads

Fastener	Concrete $N_{rec}$ [kN]	Sandlime stone $N_{rec}$ [kN]
X-FB-E or X-DFB-E with X-GN 20, X-C 20 G3 MX or X-C 20 B3 MX nails	0.02	0.02
X-FB-E or X-DFB-E with X-GN 27 or X-C 27 G3 MX nails	0.06	0.06
X-FB-E or X-DFB-E with X-GHP 20, X-P 20 G3 MX or X-P 20 B3 MX nails	0.02	-
X-FB-E or X-DFB-E with X-C 22/27 nails	0.06	0.06

## Application requirements

### Thickness of base material

X-GN, X-GHP, X-C G3 MX, X-P G3 MX

X-C B3 MX, X-P B3 MX:

$h_{min} = 60$  mm

X-C:

$h_{min} = 80$  mm

### Thickness of fastened material

**X-FB-E:** To fasten conduits, pipes and tubes of  $\varnothing$  16 mm to 25 mm

**X-DFB-E:** To fasten conduits, pipes and tubes of  $\varnothing$  20 mm to 25 mm

## Spacing and edge distances

Space fastenings as needed to control sag and maintain alignment.

## Corrosion information

These zinc-coated fasteners are not suitable for long-term service outdoors or in otherwise corrosive environments.

For further detailed information on corrosion see relevant chapter in **Direct Fastening Principles and Technique** section.

## Fastener selection and system recommendation

### Fastener program

Designation	Item no.	d [mm]	W [mm]	H [mm]
<b>X-FB-E 16 MX</b>	<b>2112585</b>	16	44	17.5
<b>X-FB-E 20 MX</b>	<b>2112586</b>	20	48	21.5
<b>X-FB-E 25 MX</b>	<b>2112587</b>	25	55	26.5
<b>X-DFB-E 20 MX</b>	<b>2112588</b>	20	80	20
<b>X-DFB-E 25 MX</b>	<b>2112589</b>	25	90	25

### Tool selection

<b>X-GN, X-GHP:</b>	GX 120
<b>X-C G3 MX, X-P G3 MX:</b>	GX 3 ME
<b>X-C B3 MX, X-C B3 MX</b>	BX 3 ME
<b>X-C_P8:</b>	DX 351-F8, DX 460-F8, DX 5 F8
<b>X-C_MX:</b>	DX 351-MX, DX 460-MX, DX 5 MX

### System recommendation

DX tools	DX 351-F8 DX 460-F8 DX 5 F8	Concrete	6.8/11M yellow cartridge soft and tough concrete
	DX 351-MX DX 460-MX DX 5 MX		6.8/11M red cartridge on very tough concrete
		Masonry	6.8/11M green cartridge
GX tools	GX 120-ME	Gas can GC 20, GC 21 and GC 22	
	GX 3 ME	Gas can GC 40, GC 41 and GC 42	
BX tools	BX 3-ME	No gas can required	

### Fastening quality assurance

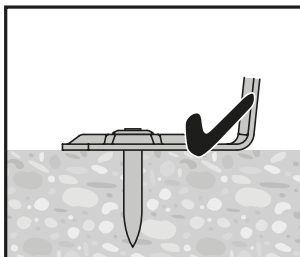

Nail head not protruding